

MARKING CONTENT ON REVERSE SIDE:

PART NO. 76022260 17.5\*6.75 15° DC DATE X X X  
 MAX LOAD 3000KG MAX KPA850  
 (ACCORDING TO CUSTOMER REQUIREMENTS,  
 TYPEFACE:SIX TIMES NEW ROMAN,  
 THE DEPTH OF WORKS:0.3MM)

Dynamic Unbalance

- 1、A≤30G
- 2、B≤30G
- 3、A+B≤50G

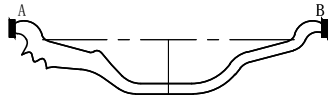

Technical note:

1. Compliance with US Federal Motor Vehicle Safety No. 120
- ★ 2. Durability Test (SAE J267)  
 Cornering Fatigue Test  
 -Loading Mode: 90°  
 -Load: 1600 ± 87kg. m  
 -Cycle: 300000
- ★ 3. Radial Fatigue Test  
 -Load: 8400 ± 346kg. m  
 -Cycle: 100000
3. Tyre: 230/70R17.5, radius: 0.393m
4. Valve balance testing standards: max 1100g. cm
5. Valve: TR554D.
6. Valve nut  
 torque: 80-125TN. LBS (8.95-14.64n. m)
7. Valve cap: 2-101
8. Two pieces nuts  
 M22-1.5, torque: 62/69kg. m
9. Tolerance  
 Dimensional Tolerance ± 1  
 Angle Tolerance ± 1°  
 Radius Tolerance ± 1

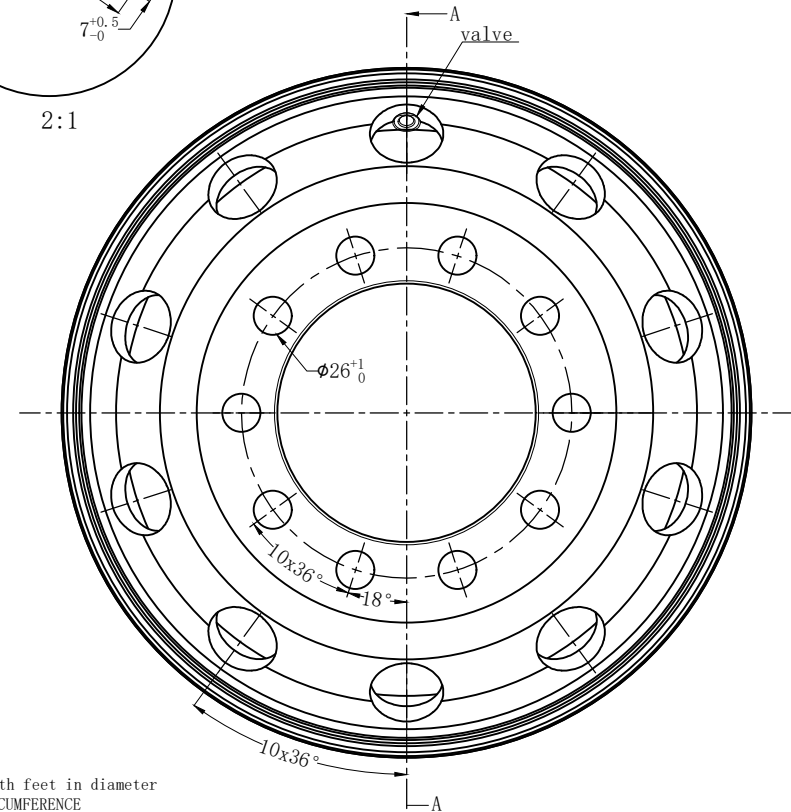
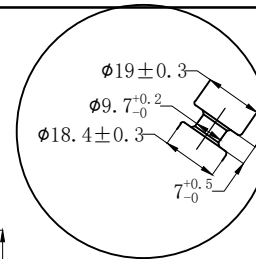
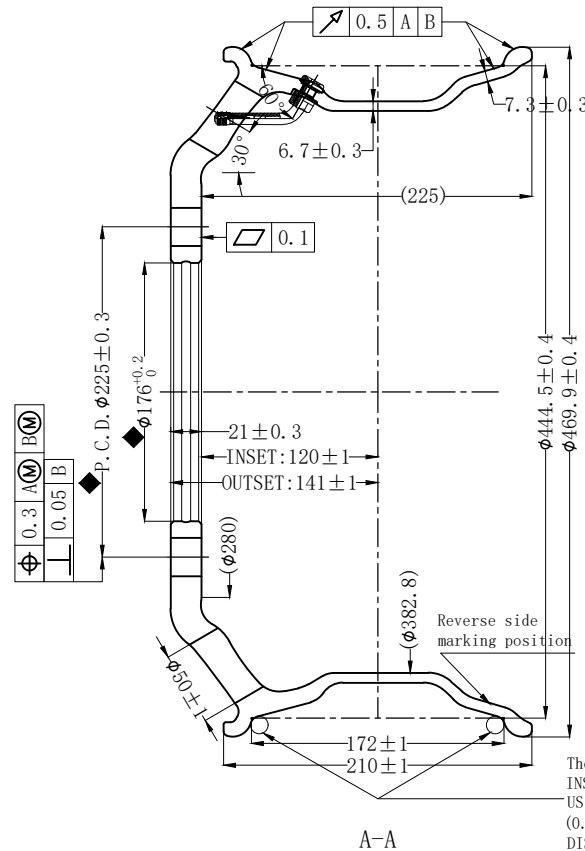

The ball with feet in diameter  
 INSPECT CIRCUMFERENCE  
 USING  $\phi 16$ MM  
 (0.629 INCHSI  
 DISE TAPE PER TIRE AND  
 RIM ASSOC SPECIFICATION

Changed the level	Place a few	Changed notification number	Changed content	Signature	Date

Important features	◆
Key Features	★

Design		Product picture	GT061-01 17.5*6.75 INSET/OUTSET: 120/141	Drawing NO.	76022260		
Proofreader				Edition	Weight (Theory)	Percentage	
Examination		Vehicle model		A/1	14.2Kg	1:1	
Technology		Surface treatment	Material/polishing	A total of one		The first page	
Standardisation				<b>QINGDAO J&amp;G</b>			
Ratification		Material	6061-T6				
Date		Projection marks					